



UNION GALVASTEEL

A PHINMA COMPANY



BEFORE



AFTER

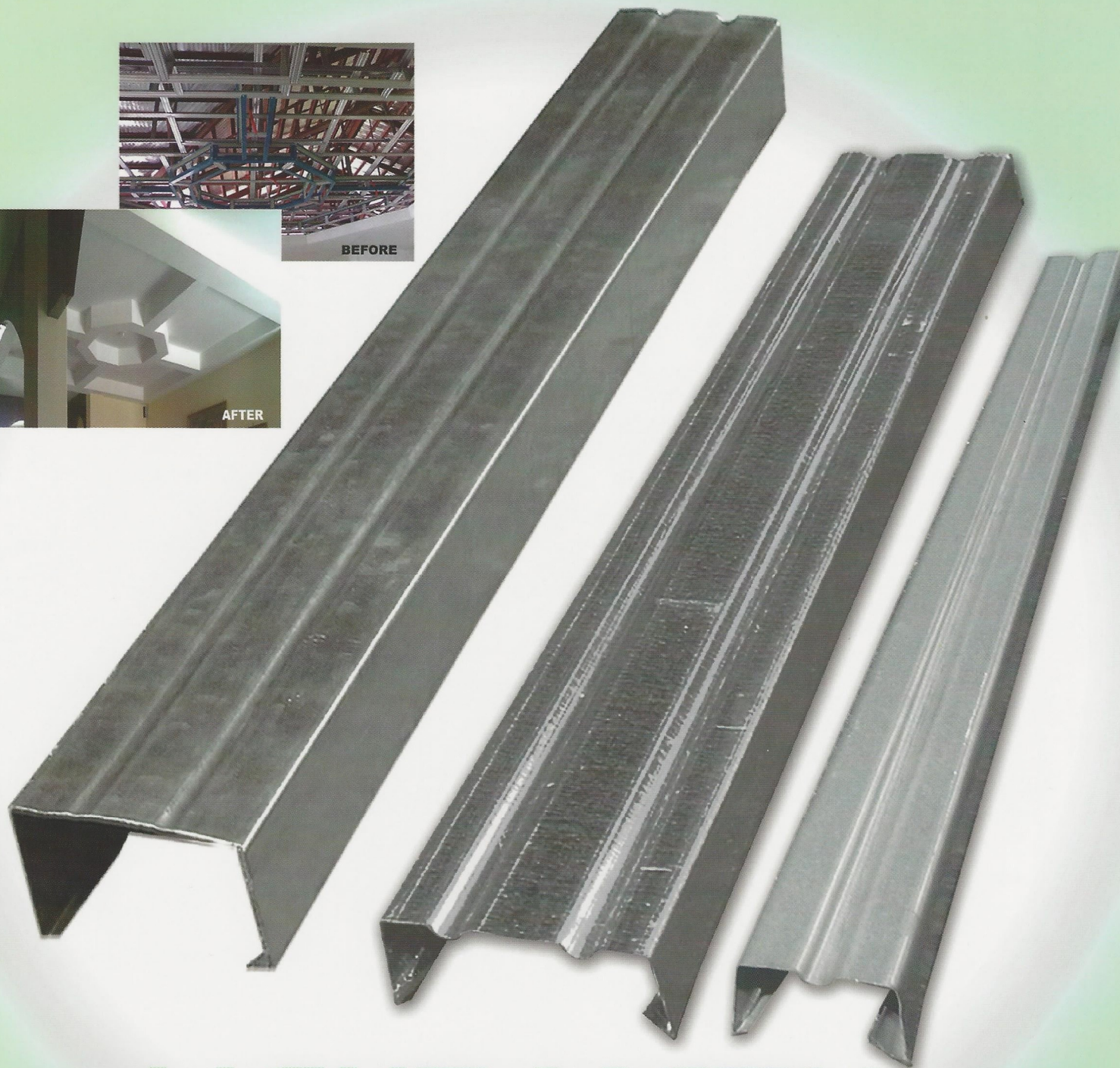

LIGHT METAL FRAMING SYSTEMS

Sa Tibay at Ganda, PANALO KAI!®

ISO 9001:2008
ISO 14001:2004
ISO CERTIFIED COMPANY

MAIN PLANT AND HEAD OFFICE: Chipeco Ave. Ext., Brgy. Real, Calamba City, Laguna

Tel. Nos.: (02) 520 8822 to 23, (02) 520 8830 to 32, (049) 545 0086 to 87 Fax Nos.: (02) 519 4205, (02) 520 8820; (049) 545 2533

www.uniongalvasteel.com.ph



SPECIFICATIONS

DIMENSION	STANDARD LENGTH
C-TRACKS 	3m
C-STUD 	3m
CARRYING CHANNEL 	5m
DOUBLE FURRING 	5m
SINGLE FURRING 	5m
WALL ANGLE 	2.44m

* Special Lengths also Available upon Request

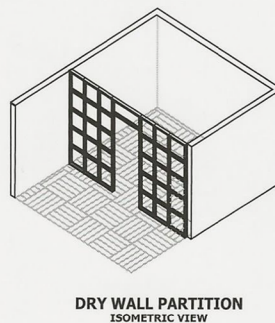
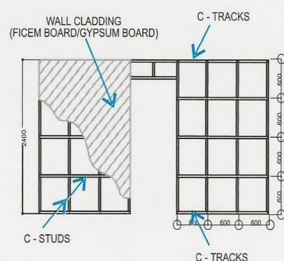
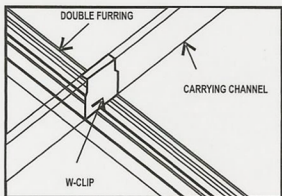
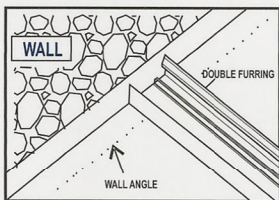

DRY WALL PARTITION
ISOMETRIC VIEW

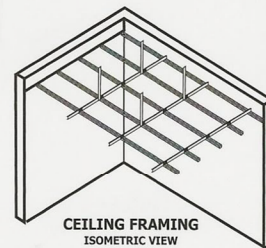

CEILING FRAMING
ISOMETRIC VIEW

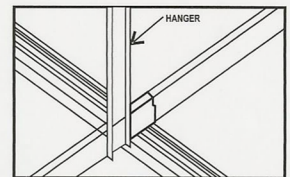

CEILING FRAMING

DESCRIPTION	THICKNESS	SPECIFICATION
Double Furring (DF)	0.40mm to 0.60mm	17mm x 49mm x 17mm x 5m
Carrying Channel (CC)	0.80mm to 1.00mm	11mm x 37mm x 11mm x 5m
Wall Angle (WA)	0.40mm	25mm x 25mm x 2.44m

MATERIALS NEEDED: 1) W-Clip; 2) Blind Rivet; 3) Concrete Nail #1

PROCEDURE

1. Wall Angle Installation.
Fasten the wall angle to the wall maintaining the perimeter level using the prescribed fastener (e.g. concrete nail for concrete surface, woodscrew for wood surface). Fasteners are spaced at 200mm interval
2. Double Furring Installation.
Attach the furring to the wall angle using blind rivets. Position the furring parallel to the longer side of the ceiling perimeter. Recommended spacing of double furring is 0.40m on center.
3. Carrying Channel Installation.
Connect the carrying channel to the furring using w-clip. The channels always run perpendicular to the double furring. Recommended spacing of channel is 0.80m to 1.00m on center.
4. Hanger Installation.
A hanger is provided to transfer the load of the carrying channel to the trusses or purlins. Spacing recommended is 1.0m to 1.5m.

DRY WALL PARTITION

DESCRIPTION	THICKNESS	SPECIFICATION
C - Studs 3m	0.40mm to 0.60mm	33.5mm x 75mm x 33.5mm x
C - Tracks	0.40mm to 0.60mm	33mm x 75mm x 33mm x 3m

MATERIALS NEEDED: 1) Blind Rivet; 2.) Concrete Nail #1

PROCEDURE

1. C-Tracks Installation.
Install the C-Tracks to the floor and ceiling to be used as guide. Use plumb bob as it is necessary for proper alignment.
2. C-Studs Installation.
C-Studs are used as vertical and horizontal joists or as nailer to the finishing cladding. Suggested spacing is 0.40mm or 0.60mm on center.

ROLLFORMING PLANTS & WAREHOUSES

La Union: Poro Point, San Fernando, La Union
Tel. Nos.: (072) 242 0331 to 32
Fax No.: (072) 888 4298

Vigan: National Highway, Zone II, Bantay, Ilocos Sur
Laoag: Brgy. Barit, Bacarra Road, Laoag City, Ilocos Norte
Tel. No.: (077) 770 3773

Benguet: Km. 6, Betag, La Trinidad, Benguet
Tel. No.: (074) 309 2934

Calasiao: Nalsian, Calasiao, Pangasinan
Tel. Nos.: (075) 523 9799, (075) 517 3970

Villasis: MacArthur Highway, Bacag, Villasis, Pangasinan

Nueva Ecija: Valenzuela, Maharlika Highway, Sta. Rosa, Nueva Ecija
Tel. Nos.: (044) 311 0412, (02) 246 5030 Fax No.: (044) 940 0451

Isabela: OLMA Bldg., Brgy. Batal, National Highway
Santiago City, Isabela
Telefax No.: (078) 305 2118

Pampanga: Brgy. Baliti, City of San Fernando, Pampanga

Cainta: Warehouse 1B, Mercedes Business Park
Brgy. San Andres, Cainta, Rizal
Telefax Nos.: (02) 628 1500, (02) 754 6271, (02) 213 1708

Cavite: Molino-Paliparan Road, Brgy. Salawag
Damarinas City, Cavite
Tel. No.: (046) 850 5075

Batangas: Brgy. Soro-Soro Karsada, Batangas City
Tel. No.: (043) 702 5940

Lucena: Purok Jasmin, Brgy. Domoit
Diversion Road, Lucena City
Tel. No.: (042) 373 3017

Bicol: Princeton Warehouse, San Jose, Pili, Camarines Sur
Tel. Nos.: (054) 477 7000, (054) 477 0397

Cebu: National Hi-way, Tayud, Consolacion, Cebu
Tel. Nos.: (032) 260 4429, (032) 260 4432

Iloilo: Balantang, Jaro, Iloilo City
Telefax Nos.: (033) 508 5087, (033) 329 4119

Bacolod: LKI Bldg., Lacson Extension St.
Brgy. Singang-Airport, Bacolod City
Tel. No.: (034) 435 7175
Telefax No.: (034) 433 9092

Tacloban: National Highway
Brgy. 82, Marasbaras, Tacloban City
Tel. No.: (053) 323 6003
Telefax No.: (053) 323 8222

Davao: Bo. Ilang, Davao City
Tel. Nos.: (082) 238 0592, (082) 238 0593
(082) 238 0064, (082) 238 0649
(082) 238 0004, (082) 238 0005

General Santos: Km. 3, BTY Compound
National Hi-way, General Santos City
Tel. Nos.: (083) 301 9299, (083) 301 9300

Butuan: Door 3, Butuan Premier Warehouse
Km. 4, Baan, Butuan City
Tel. No.: (085) 342 6497

Zamboanga: Veterans Extension
Sta. Maria, Zamboanga City
Tel. Nos.: (062) 992 7959, (062) 992 7957

Cagayan de Oro: Cor. Malasag Road
Zone 9, Cugman, Cagayan de Oro City
Tel. Nos.: (088) 855 1563, (088) 855 1684

Bukidnon: Roque Compound, Purok 17-A
Hagkol Poblacion, Valencia City, Bukidnon
Tel. No.: (088) 828 3662

Ozamiz: Rizal Ave., Lam-an, Ozamiz City
Tel. Nos.: (088) 521 5002, (088) 521 4998